

STAND S



SUGGESTED USE

- Stand S is a standalone anti-theft protection dedicated to smartphones and tablets.
- UMH3, UMH4 and DFO2 sensors allow aesthetic product presentation.
- Small size assures optimal visibility of the product.

WARNING!

After connecting the device to a charger, a periodically blinking yellow diode in the base indicates lack of any programmed remote controls.

The image below shows the components needed to assemble the whole system.

- 1) Stand S + DC extension
- 2) power supply 19V/3.42A
- 3) charging cable
- 4) cleaning tissue with isopropoxide
- 5) smartphone

Cleaning tissue with isopropoxide assures proper preparation of the surface for Optiguard stickers.



STAND S

Through using the cleaning tissue with isopropoxide we can prepare the surface of the furniture which Stand S will be attached to. After cleaning the furniture wait until the cleaning substance evaporates.



Take off the protective papers from the stickers.



Plug the DC extension connector to the DC port. Place the cable inside the special groove underneath the base of the Stand S.

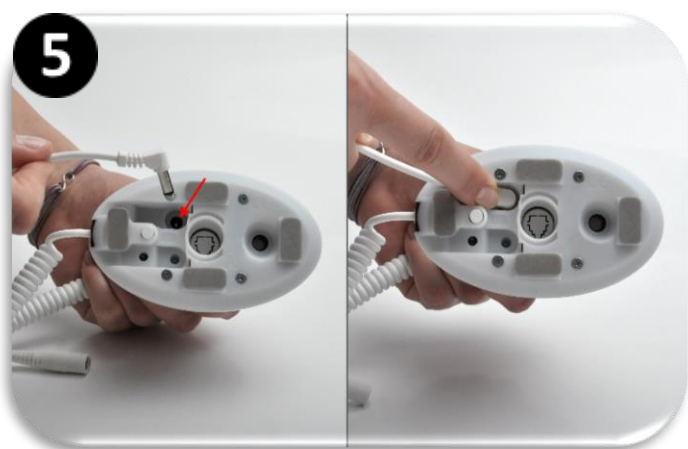

Stick Stand S to the furniture and press for approx. 10 seconds for good bonding of the sticker adhesive.



STAND S

Through using the cleaning tissue with isopropoxide we can prepare the surface of the device which sensor will be attached to. After cleaning the device wait until the cleaning substance evaporates.



Stick the phone to the sensor and press for approx. 10 seconds for good bonding of the sticker adhesive.



Take off the protective paper from the sticker of the UMH3



The charging cable allows connecting the protective sensor. The smartphone will be simultaneously charged and protected.



STAND S

Plug one end of the charging cable which says "ALARM" into the microUSB port of the smartphone.



Plug the other end of the charging cable into the microUSB port of the UMH3 sensor.



19V/3.42A power supply provides enough power for Stand S and allows charging the protected product.



Connect the power supply connector to the DC extension cable.



STAND S

Plug the power supply with the Stand S connected to it into the electrical outlet (AC 230V).



Powered Stand S will be activated within 3 seconds. Short acoustic signal and periodically blinking red LEDs in the sensor confirm activation of the system. Finished!

